

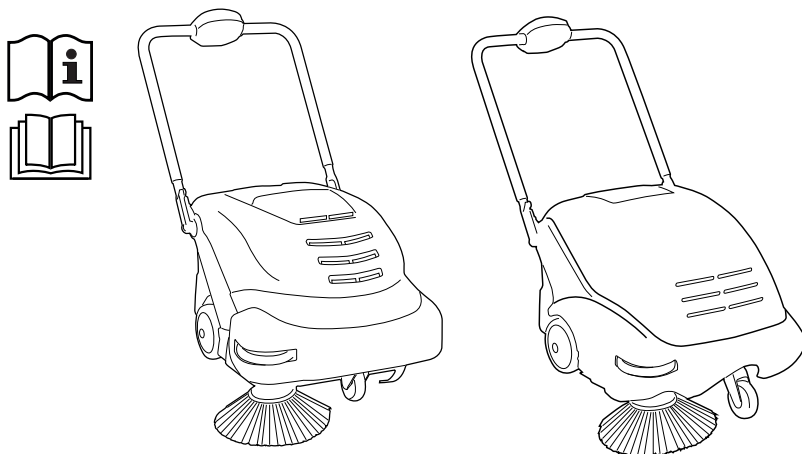

IPC

# 464 - 664 - JET 460 - JET 660 - LION 460 - LION 500 - LION 600 - SR 464 - SR 664



**(IT)** MANUALE ISTRUZIONI PER L'USO /  
**(EN)** OPERATOR'S MANUAL / **(FR)** MANUEL D'INSTRUCTIONS /  
**(DE)** BEDIENUNGSANLEITUNG / **(ES)** MANUAL DE INSTRUCCIONES /  
**(NO)** BRUKERHÅNDBOK / **(NL)** GEBRUIKERSHANDLEIDING /  
**(PT)** MANUAL DE UTILIZAÇÃO / **(SE)** INSTRUKTIONSBOK /  
**(RU)** РУКОВОДСТВО ОПЕРАТОРА / **(CN)** 操作手册

Consultare attentamente questo manuale prima di procedere a qualsiasi intervento sulla macchina  
Read this manual carefully before carrying out any work on the machine  
Lire attentivement ce manuel avant toute intervention sur la machine  
Vorliegendes Handbuch vor jedem Eingriff an der Maschine aufmerksam durchlesen  
Consulte detenidamente este manual antes de llevar a cabo cualquier trabajo en la máquina  
Konsulter denne håndboken nøye før du går i gang med noen som helst type inngrep på maskinen  
Raadpleeg deze handleiding aandachtig alvorens met enige werkzaamheid aan de machine te beginnen  
Consulte atentamente este manual antes de efectuar qualquer intervenção na máquina  
Läs noggrant igenom denna handbok innan du utför något som helst ingrepp på maskinen  
Прочетете внимателно това ръководство, преди да започнете работа с машината  
操作机器之前请认真阅读本手册。

<b>SAFETY PRECAUTIONS:</b>	<b>2</b>
<b>TECHNICAL CHARACTERISTICS 464:</b>	<b>5</b>
<b>TECHNICAL CHARACTERISTICS 664:</b>	<b>6</b>
<b>IDENTIFYING THE MACHINE</b>	<b>7</b>
<b>UNPACKING:</b>	<b>7</b>
<b>PREPARING THE MACHINE:</b>	<b>7</b>
<b>CONTROL PANEL AND MACHINE COMPONENTS:</b>	<b>8</b>
<b>USING THE ON-BOARD BATTERY CHARGER:</b>	<b>9</b>
<b>STARTING THE MACHINE:</b>	<b>9</b>
<b>INSTRUCTIONS FOR CORRECT OPERATION:</b>	<b>10</b>
<b>CLEANING THE DEBRIS BIN:</b>	<b>10</b>
<b>MACHINE MAINTENANCE:</b>	<b>11</b>
<b>SIDE BRUSH REPLACEMENT:</b>	<b>11</b>
<b>CENTRE BRUSH REPLACEMENT:</b>	<b>11</b>
<b>CLEANING AND SERVICING THE FILTER:</b>	<b>11</b>
<b>ACTUATOR OPERATION:</b>	<b>12</b>
<b>ADJUSTING THE SIDE BRUSH:</b>	<b>12</b>
<b>FLAP RAISER:</b>	<b>12</b>
<b>REMOVING THE BATTERY:</b>	<b>12</b>
<b>TABLE OF ALARM AND ERROR CODES:</b>	<b>14</b>
<b>PROGRAMMING:</b>	<b>14</b>

## **SAFETY PRECAUTIONS:**

This machine is intended for commercial use, for example in hotels, schools, hospitals, factories, shops, offices and business premises generally.

It is designed to pick up dirt, dry debris and dust from dry hard floor or carpeted surfaces in an indoor environment. It is not constructed for any other use. The pick up of any type of liquid substance or dangerous/toxic materials is prohibited.

The machine must be used exclusively by persons trained in its use and/or who have demonstrated their ability and have been expressly authorised to use it. All operators must read, understand and practice the following safety precautions.

The machine is not intended for use by persons (including children) with reduced physical, sensory or mental capabilities, or lack of experience and knowledge, unless they are supervised by a person responsible for their safety and have received instruction in the use of the machine.

The following warning alert symbol and the "FOR SAFETY" heading are used throughout this manual as indicated in their description:

 **WARNING: to warn of hazards or unsafe practices which could result in severe personal injury or death.**

**FOR SAFETY: to identify actions which must be followed for safe operation of equipment.**

**Failure to follow these warnings may result in: personal injury, electrocution, electric shock, fire or explosion:**

 **WARNING: do not operate machine in or near flammable liquids, vapours or combustible dusts.**

**This machine is not equipped with explosion proof motors. The electric motors will spark upon start up and**

**during operation which could cause a flash fire or explosion if machine is used in an area where flammable vapours/liquids or combustible dusts are present.**

 **WARNING: do not pick up flammable or toxic material, burning or smoking debris.**

 **WARNING: do not charge the batteries using damaged power cables. Do not modify the plug.**

**If the charger power cable is damaged or broken, it must be replaced by the manufacturer or it's service agent or a similarly qualified person in order to avoid a hazard.**

 **WARNING: disconnect battery cables and unplug charger power cable before servicing the machine.**

 **WARNING: do not use outdoors or on wet surfaces. Do not expose to rain. Store indoors.**

 **WARNING: Installation and connection / removal of the batteries must be carried out by an IPC-approved technician (hereinafter referred to as qualified personnel).**

**The following information signals potentially dangerous conditions to the operator or equipment:**

**FOR SAFETY:**

- **Do not operate the machine:**
  - in flammable or explosive areas.
  - unless trained and authorised.

- without having first read and understood the user manual;
- if not in proper operating condition;
- without the bin and/or filters in place.
- **Before starting the machine:**
  - make sure all safety devices are in place and operate properly.
- **When using the machine:**
  - do not pick up burning or smoking debris, such as cigarettes, matches or hot ashes;
  - do not operate in standing water;
  - report machine damage or faulty operation immediately;
  - go slow on inclines and slippery surfaces;
  - do not use for cleaning surfaces with a slope steeper than that indicated on the machine.
  - do not leave unattended or parked on an uneven surface;
  - do not pick up cables, strings, wires or other similar material;
  - make sure the work area is well lit;
  - never allow children to play on or around the machine;
  - do not transport riders or objects;
  - wear a dust mask, protective glasses and gloves in dusty environments.
- **Before leaving or servicing the machine:**
  - park on a level surface;
  - turn the machine off.
- **When servicing the machine:**
  - keep hair, loose garments, fingers and all other parts of the body well clear of slots and moving parts;
- disconnect the battery connection and charger plug before working on the machine;
- use manufacturer supplied or approved replacement parts. All repairs must be performed by a qualified service person;
- do not modify the machine from its original design.
- **When transporting the machine:**
  - turn the machine off;
  - get assistance when lifting the machine;
  - use a recommended ramp when loading/unloading into/off a truck or trailer;
  - use tie-down straps to secure the machine to the truck or trailer
- **Battery:**
  - Do not use NON-rechargeable batteries
  - The battery is a sealed unit and guaranteed safe under normal circumstances; in the unlikely event of fluid leaking from the battery, do not touch the fluid and be sure to take the following precautions:
    - Contact with the skin can cause irritation; wash with soap and water.
    - Inhalation of vapours can cause irritation to the airways; stay out in the open air and consult a doctor.
    - Contact with the eyes can cause irritation; flood the eyes with water immediately and thoroughly for at least 15 minutes, and consult a doctor.

- **This product is covered by and responds to the requirements of the Waste Electrical and Electronic Equipment directive (2002/96/EC WEEE). It must be disposed of separately from ordinary waste in compliance with current legislation and standards.**

**Special waste. Do not dispose of with ordinary waste.**



## TECHNICAL CHARACTERISTICS 464:

Description		464 230V	464 120V	464 100V
Width-including side brush	mm	600	600	600
Length-including side brush	mm	730	730	730
Height-including handle	mm	950	950	950
Machine height w/ handle folded	mm	559	559	559
Maximum sweeping width	mm	650	650	650
Bin capacity (real)	l	26,7	26,7	26,7
Operating autonomy	h	2	2	2
Filtering area	m <sup>2</sup>	0,95	0,95	0,95
Theoretical productivity	m <sup>2</sup> /h	1800	1800	1800
Productivity rate-actual	m <sup>2</sup> /h	900	900	900
Overall power of machine in average operating conditions (P <sub>M</sub> )	W	165	165	165
Maximum slope	%	2	2	2
Gross weight (GVW)	kg	103	103	103
Transport weight of the machine with battery and empty debris bin	kg	63	63	63
Transport weight of the machine without battery, with empty debris bin	kg	49	49	49
Number of batteries	no.	1	1	1
Machine voltage V <sub>M</sub>	V	12V dc	12V dc	12V dc
Individual battery capacity	Ah (5h)	31	31	31
Mains supply voltage	V	230V ac (50-60Hz)	120V ac (60Hz)	100V ac (50-60Hz)
Max current (amperes), I	A	1.3A max	2.5A max	2.9A max
Sound pressure - EN 60335-2-72	L <sub>pA</sub> (dBA)	57	57	57
Measurement uncertainty	K(dBA)	3	3	3
Measured sound power (LWA) + UNCERTAINTY (KWA) - EN 60335-2-72	L <sub>WA</sub> +K <sub>WA</sub> (dBA)	63	63	63
Vibration level (hand) - IEC 60335-2-72	ahv (m/ sec <sup>2</sup> )	≤2.5	≤2.5	≤2.5
Measurement uncertainty, k	m/sec <sup>2</sup>	/	/	/
IP degree		IPX0	IPX0	IPX0

Gross weight (GVW): maximum permissible weight with the machine fully loaded and ready for use. The gross weight of the vehicle includes, when applicable, detergent solution tank full of clean water, empty dirty water tank (half full in the case of recycling systems), empty dust bags, the hopper filled to its rated capacity, the largest recommended batteries and all accessories such as cables, hoses, detergent, mops and brushes. Transported weight: the weight of the machine including the batteries, but excluding optionals (for example, the operator's cabin, FOPS (Falling Object Protective Structure), second and third side brushes and front brush attachment), fresh water (in the case of scrubbers or combined machines) and the weight of a standard operator (75 kg)

Data subject to changes without prior warning

V, I: charging / supply values

V<sub>M</sub>, P<sub>M</sub>: machine in operation (all functions on)

## TECHNICAL CHARACTERISTICS 664:

Description		664 230V	664 120V	664 100V
Width-including side brush	mm	xx	xx	xx
Length-including side brush	mm	730	730	730
Height-including handle	mm	950	950	950
Machine height w/ handle folded	mm	559	559	559
Maximum sweeping width	mm	xx	xx	xx
Bin capacity (real)	l	39,3	39,3	39,3
Operating autonomy	h	2	2	2
Filtering area	m <sup>2</sup>	0,95	0,95	0,95
Theoretical productivity	m <sup>2</sup> /h	XXXX	XXXX	XXXX
Productivity rate-actual	m <sup>2</sup> /h	xxx	xxx	xxx
Overall power of machine in average operating conditions (P <sub>M</sub> )	W	165	165	165
Maximum slope	%	2	2	2
Gross weight (GVW)	kg	131	131	131
Transport weight of the machine with battery and empty debris bin	kg	63	63	63
Transport weight of the machine without battery, with empty debris bin	kg	49	49	49
Number of batteries	no.	1	1	1
Machine voltage V <sub>M</sub>	V	12V dc	12V dc	12V dc
Individual battery capacity	Ah (5h)	31	31	31
Mains supply voltage	V	230V ac (50-60Hz)	120V ac (60Hz)	100V ac (50-60Hz)
Max current (amperes), I	A	1.3A max	2.5A max	2.9A max
Sound pressure - EN 60335-2-72	L <sub>pA</sub> (dBA)	57	57	57
Measurement uncertainty	K(dBA)	3	3	3
Measured sound power (LWA) + UNCERTAINTY (KWA) - EN 60335-2-72	L <sub>WA</sub> +K <sub>WA</sub> (dBA)	63	63	63
Vibration level (hand) - IEC 60335-2-72	ahv (m/ sec <sup>2</sup> )	≤2.5	≤2.5	≤2.5
Measurement uncertainty, k	m/sec <sup>2</sup>	/	/	/
IP degree		IPX0	IPX0	IPX0

Gross weight (GVW): maximum permissible weight with the machine fully loaded and ready for use. The gross weight of the vehicle includes, when applicable, detergent solution tank full of clean water, empty dirty water tank (half full in the case of recycling systems), empty dust bags, the hopper filled to its rated capacity, the largest recommended batteries and all accessories such as cables, hoses, detergent, mops and brushes.

Transported weight: the weight of the machine including the batteries, but excluding optionals (for example, the operator's cabin, FOPS (Falling Object Protective Structure), second and third side brushes and front brush attachment), fresh water (in the case of scrubbers or combined machines) and the weight of a standard operator (75 kg)

Data subject to changes without prior warning

V, I: charging / supply values

V<sub>M</sub>, P<sub>M</sub>: machine in operation (all functions on)

## IDENTIFYING THE MACHINE

The nameplate provides the following information:

- Name of manufacturer.
- Model
- Serial number.
- Year of manufacture.
- Power supply voltage (charging/supply values).
- Current intensity (charging value).
- Gross weight.
- IP degree of protection.
- Machine voltage (in average working conditions).
- Machine power (in average operating conditions)
- Maximum negotiable gradient.

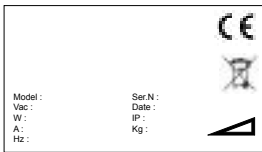

## UNPACKING:

Unpack your machine with great care, avoiding any manoeuvre that could lead to damage. Once you have unpacked it, make sure all parts are in a good condition. If you notice any damage, DO NOT use the machine and contact your retailer immediately.

Due to packaging and transport requirements, some parts and optionals may be supplied separately; for correct assembly, follow the instructions given in the corresponding chapters of this booklet.

Contents of the packaging:

- Machine.
- Side brush.
- User and maintenance manual.
- Warranty.
- Gel battery.
- 4 mm hex wrench.
- T20A fuse, functions board.
- Battery charger fuse.
- F2.5A actuator fuse.
- T6,3A side brush motor fuse.
- T5A suction motor fuse.
- F2,5A filter shaker fuse.
- Charger extension cord.

If you notice that any of the above are missing, contact your retailer immediately.

Make sure the packaging materials (bags, boxes, pallets, hooks, etc.) are put away, out of the reach of children.

## PREPARING THE MACHINE:

Fitting the side brush:

- raise the front part of the machine and attach the side brush, as shown in the figure.

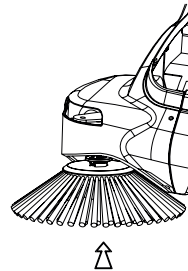

Handle assembly:

- release the handle locks to allow room for the handle to be turned.
- tilt the handle to the desired position.
- lock the handle again.

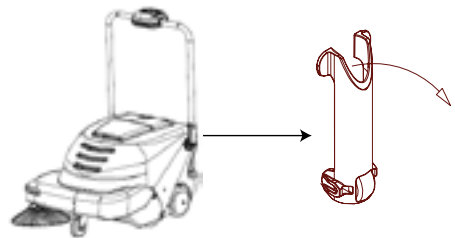

Connecting the battery:

Undo the fixing screws to open the top cowling. The machine is delivered by the manufacturer with the battery disconnected from the electrical system. The operator must connect the two connectors, as shown in the drawing.



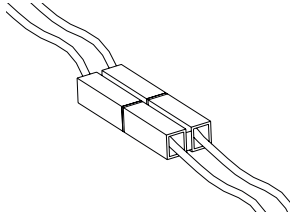

Close the top cowling.

## CONTROL PANEL AND MACHINE COMPONENTS:

The machine is equipped with a simple and intuitive control panel that controls all the functions of the machine.

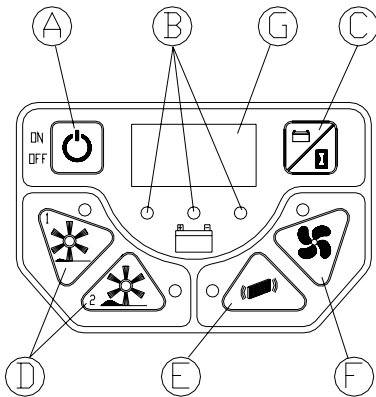

- A) Machine "ON/OFF" button.
- B) LED indicator for battery charge.
- C) Display button.
- D) Work program 1 and 2 on-off buttons.
- E) Button for manual activation of the filter shaker function.
- F) Button for turning off the suction motor.
- G) Numeric display.

The functions on the control panel can be summarised as follows:

- A) Main switch to turn the machine on and off.
- B) Battery charge status indicator LEDs: this function provides useful information on battery charge status.

Meaning of the LED colours:

green LED on, the battery is charged, red LED on the battery is discharged, yellow LED on the battery is being recharged via the power supply, or battery charge is low.

C) Display button: pressing this button shows the machine voltage, and machine operating hours (pressing once) and minutes (pressing twice).

D) Work program 1 and 2 on-off buttons: these two buttons allow the machine to work in two separate modes: program 1 for light debris collection, and program 2 for heavy debris collection, when the area being cleaned is much dirtier.

E) Button for activating the filter shaker function: this button is used to activate the filter shaker at any time when working.

F) Button for activating the suction motor: this button stops the suction function.

G) Numeric display.

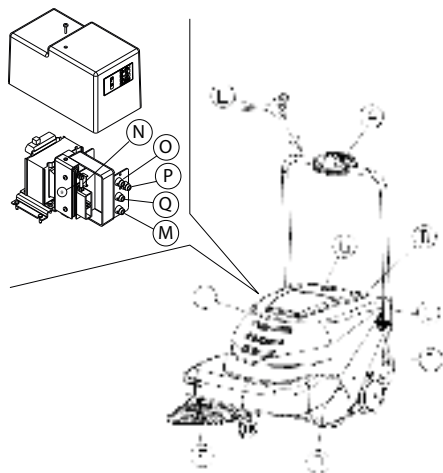

- A) CONTROL PANEL  
B) CHARGER FUSE

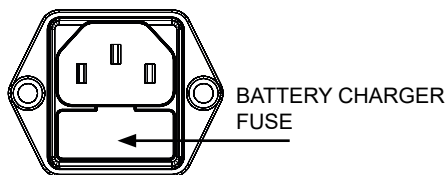

- C) HANDLE RELEASE  
D) BUMPER  
E) SIDE BRUSH  
F) TOP COWLING  
G) CHARGER EXTENSION CORD COMPARTMENT  
I) DEBRIS BIN  
L) FLAP RAISER (MODELS 664, JET660, LION600, SR664)  
M) ACTUATOR FUSE (F2,5A)  
N) CENTRAL BRUSH MOTOR FUSE (T20A).  
O) SIDE BRUSH MOTOR FUSE (T6,3A).  
P) VACUUM FAN MOTOR FUSE (T5A).  
Q) FILTER SHAKER FUSE (F2,5A).

## USING THE ON-BOARD BATTERY CHARGER:

When the battery on the machine is discharged, the red LED on the control panel comes on and all the machine functions will automatically stop: the operator must then turn off the machine and start the charging procedure by connecting the machine battery charger plug into a power socket (when recharging, the yellow LED on the control panel comes on).

Once the battery has been recharged, the green LED on the control panel will come on and the operator can resume work, once having unplugged the machine from the socket.

**NOTE: USING THE MACHINE BEFORE THE BATTERY HAS FULLY CHARGED (GREEN LED ON) WILL REDUCE THE LIFE AND RUNNING TIME OF THE BATTERY.**

**⚠ WARNING: The charger on this machine is built specifically for recharging GEL batteries**

**NOTE: If during operation the machine battery charger plug is connected, the machine will automatically stop all its functions.**

## STARTING THE MACHINE:

**⚠ WARNING: the machine must be used only by authorised personal, DO NOT LEAVE the machine when switched on, do not use the machine for collecting liquid, turn the machine OFF before leaving the machine. KEEP THE MACHINE OUT OF THE REACH OF CHILDREN.**

To start the machine, proceed as follows:

- press the machine's on/off button.
- check that the green LED (battery charge status indicator) is on.
- select the appropriate work program: Press the work program button 1 for smooth surfaces and light debris. Press the work program button 2 for very dirty surfaces, asphalt, carpet.

NOTE: using work program 2 reduces the machine's operating time.

## **INSTRUCTIONS FOR CORRECT OPERATION:**

After having followed all operations for starting the machine, the machine is now ready to work as a sweeper. To achieve the maximum performance, follow the procedures in this manual to avoid the risk of damaging the machine.

Important:

- do not pick up wires, ropes, straps, water or other liquids. If the work environment/ floor is damp, it is essential to turn off the suction fan, as the filter could be damaged.
- In the presence of bulky or particularly light objects (paper, leaves, etc.), raise the front of the machine by pushing on the handle while picking up the waste.

Operate the filter shaker at the end of the job.

**⚠ WARNING: this machine is not intended for wet surface sweeping. However, if you encounter a slightly damp environment (moisture build-up on the floor), the suction fan must be switched off to prevent filter damage. Machine damage due to wet debris pick-up is not covered under warranty.**

**⚠ WARNING: if the sweeper remains inactive for a period longer than one month, disconnect the RED and BLACK battery clips. If it remains off for more than a week, leave the sweeper connected to the mains with the cable supplied (battery charger power cable).**

## **CLEANING THE DEBRIS BIN:**

Before emptying the bin, make sure all machine functions are turned off.

**⚠ WARNING: WASTE DISPOSAL MUST BE PERFORMED STRICTLY FOLLOWING THE LAWS IN FORCE.**

To clean the rear debris bin, proceed as follows:

- lift and turn the two rear bin locking devices.
- hold the rear bin by the handle and pull it out of the machine.
- empty the bin.

To replace the bin:

- insert the bin into the machine.
- turn and press the lock.

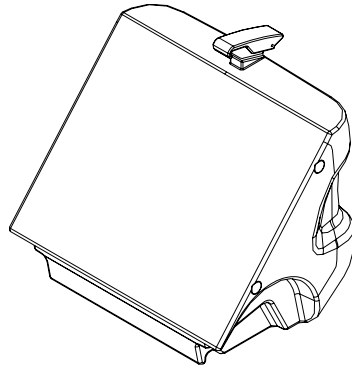

## MACHINE MAINTENANCE:

Machine maintenance must be carried out in AUTHORISED centres and by AUTHORISED personnel.

It is recommended to ONLY use original spare parts.

Before starting any type of maintenance, stop the sweeper and switch it off by pressing the ON/OFF button on the control panel.

CHECKLIST	On delivery	Daily	Every 10 hours	Every 20 hours	Every 50 hours	Every 100 hours
Check belt wear						X
Check tightness of nuts and bolts					X	
Check the condition of the brushes					X	
Check tightness of the gaskets			X			
Check all of the functions	X	X	X	X	X	X
Check the debris bin		X				
Remove and shake the pre-filter		X				
Check the filter				X		

## SIDE BRUSH REPLACEMENT:

After having raised the front of the machine, remove the brush using the release device (see drawing). Replace and reattach the brush.

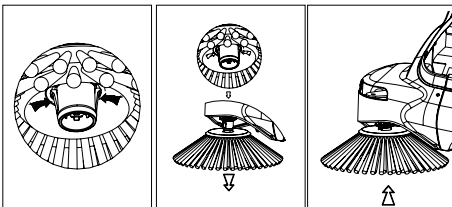

## CENTRE BRUSH REPLACEMENT:

To replace the centre brush, proceed as follows:

- lay the machine down so that the brush compartment is exposed
- turn the brush to the point at which a black button positioned on the extreme right can be seen.
- press the black button and push the brush inwards.
- remove the worn centre brush and fit the new brush, making certain that it is locked in place by the black button.

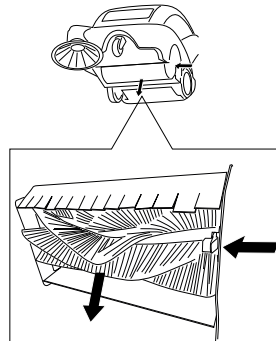

## CLEANING AND SERVICING THE FILTER:

The suction filter makes a major contribution to the efficiency of the whole machine. Proper filter maintenance will allow you to obtain the best performance from your machine.

### Pre-filter

#### Daily cleaning

- remove the rear bin.
- release the two metal arms holding the pre-filter, remove the pre-filter.
- shake the pre-filter into a container.
- fit the pre-filter again, locking it with the two metal arms.

### Main filter

The filter can be cleaned in three ways:

- using the automatic cleaning system. Selecting the work program, the machine is programmed for automatic and cyclical cleaning of the filter at pre-defined intervals (3 MINUTES).

- using an electric filter shaker with manual activation; with a simple gesture, the filter can be kept in perfect conditions at all times. Press the button and hold it down for a few seconds. Repeat this operation 4 or 5 times. Remember that the cleaner the filter is, the better the results of cleaning will be. This operation should be performed at the end of every working cycle.

**NOTE: Dusty environment**

**If the machine is used in a dusty environment (e.g. sawmills, warehouses where vehicles operate, etc.), make sure to use the filter shaker more frequently.**

- cleaning the filter manually. If the filter shaker is not effective in cleaning the filter, and in any case every 20 operating hours, clean the filter manually. Before carrying out any type of work on the machine, make sure that it is switched off and that all of the functions are deactivated. To

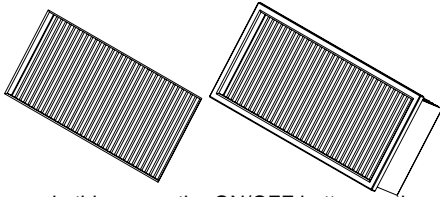

do this, press the ON/OFF button on the control panel.

- remove the rear bin.
- remove the pre-filter and the filter from their housings.
- blow the filter clean with compressed air (maximum pressure 6 bars).
- reassemble the filter and reposition the rear bin.

**ACTUATOR OPERATION:**

The pressure of the brushes is automatically adjusted by a system that ensures the brushes immediately and constantly follow the different levels of the floor or ground.

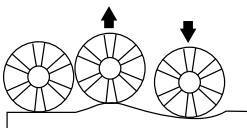

**ADJUSTING THE SIDE BRUSH:**

To adjust the side brush, remove the top cowling and turn the handwheel clockwise or anticlockwise

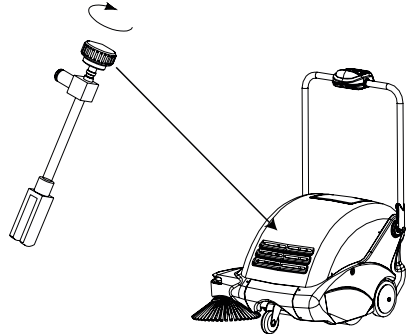

**FLAP RAISER:**

(MODELS: 664, JET660, LION600, SR664)

To allow the collection of voluminous solid waste, raise the flap using the lever on the handle. However, as far as possible, avoid using the sweeper with the flap raised, as cleaning will be less efficient.

**REMOVING THE BATTERY:**

**⚠ WARNING: Installation and connection / removal of the batteries must be carried out by an IPC-approved technician (hereinafter referred to as qualified personnel).**

**⚠ WARNING: the battery is a sealed unit and guaranteed safe under normal conditions; in the unlikely event of fluid leaking from the battery, do not touch the fluid and be sure to take the following precautions:**

- Contact with the skin can cause irritation; wash with soap and water.
- Inhalation of vapours can cause irritation to the airways; stay out in the open air and consult a doctor.
- Contact with the eyes can cause irritation; flood the eyes with water immediately and thoroughly for at least 15 minutes, and consult a doctor.

When removing the batteries, the operator must be equipped with suitable personal protection devices (gloves, goggles, overalls, safety shoes, etc.) to reduce the risk of injury. Make sure the switches on the control panel are in the "0" position (off) and the machine is turned off. Keep away from naked flames, do not short circuit the battery poles, do not cause sparks and do not smoke. Proceed as follows:

- disconnect the battery cables from the battery poles.
- if necessary, remove the devices fixing the battery to the base of the machine.
- lift the batteries from the compartment using suitable lifting equipment.

## TABLE OF ALARM AND ERROR CODES:

Alarm message	Event	Actions to take
C22	Brush protection short circuit: inhibits all functions.	Resettable only by pressing the OFF button of the machine.
C14	Heatsink overtemperature: activated if the temperature exceeds 90°C (194°F).	Error condition resets automatically when the temperature drops below 90°C (176°F).
FS0	Worn brushes.	Replace brushes.
SP1	Brush fault	Error resettable only by switching off the machine. Trips if the brushes cut out three times within the space of one minute.
Yellow Led alight	Battery reserve charge.	Error condition that does not inhibit any function: the condition is indicated by the yellow Led lighting up.
Red Led blinking	Reserve charge depleted.	Error condition inhibiting all functions: resettable only by pressing the OFF button on the machine.
P1.X	Value of "work program 1" parameter.	See programming.
P2.X	Value of "work program 2" parameter.	See programming.
SF.X	Value of "filter shaker function" parameter.	See programming.

X = VALUE RANGING BETWEEN "0" AND "9"

### PROGRAMMING:

If the display shows P1.0, P2.1, and SF.3, simply switch off the machine. (these settings are programmed by the manufacturer).

If the display shows a value higher than those indicated above (e.g. P1."5", P2."7", SF."9") continue to follow the instructions given below.

To restore the default factory settings for the machine, set the power switch to ON, then press the programming button on the control panel (battery/hourglass symbols) and hold for at least 3 seconds.

P1.X will appear in the display. Value "P1" should be "0" (P1.0); if the value displayed is higher than "0", press the "activate suction fan" button to return the value in the display to "P1.0". Press the programming button (battery/hourglass symbols) to move to the next parameter.

Value "P2" should be "1" (P2.1); if a different value is displayed, press the "activate suction fan" button to set the correct value. Press the programming button (battery/hourglass symbols) to pass on to the final parameter.

Value "SF.X" should be SF.3; if a different value is displayed, press the "filter shaker" button to set the correct value.

To exit programming mode, switch off the machine.



**IPC**

IP Cleaning S.r.l  
Viale Treviso 63  
30026 Summaga di Portogruaro  
Venezia (Italy)  
T: +39 0421 205511  
F: +39 0421 204227  
E: [www.ipcworldwide.com](http://www.ipcworldwide.com)  
W: [info@ipcworldwide.com](mailto:info@ipcworldwide.com)

